



PRO SERIES

ProCapture-X

PoE Fingerprint Access Control Reader

ProCapture-X is a next-generation access control reader utilizing advanced SilkID fingerprint sensor technology.



Biometric Performance:

Reliable, durable and highly accurate SilkID fingerprint sensor with latest fingerprint matching algorithm which provides less than 1.5 second user recognition.

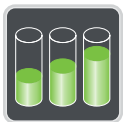

Capacity:

Stores up to 20,000 fingerprint templates and 50,000 cards. Data can be backed up to a USB flash drive and transferred to another ProCapture-T in the absence of network connectivity.



Communication:

Weigand output for connecting to an access control panel and Ethernet port for fast and reliable network communication. Optional Wi-Fi available.



Options:

ProCapture-X can be configured with optional internal modules which read HID Prox, HID iclass or 13.56 MHz Mifare cards.



Easy Operation and Management:

Works without a computer. Complete setup and programming can be done via the ProCapture-X keypad and embedded firmware. Audio-Visual Indication for acceptance and rejection of valid/invalid fingerprints, cards and passwords.



Full Access Control Built In:

Relay Outputs for electric lock and alarm. Inputs for door status sensor and request to exit hardware. Supports multiple time zones and personnel groups for programming valid entry zones.



For Software Developers:

Free SDK and development tools are available for developers/partners who wish to integrate ProCapture-X with any application which requires verifying people. Custom development is also available for OEM partners upon request.

Configuration

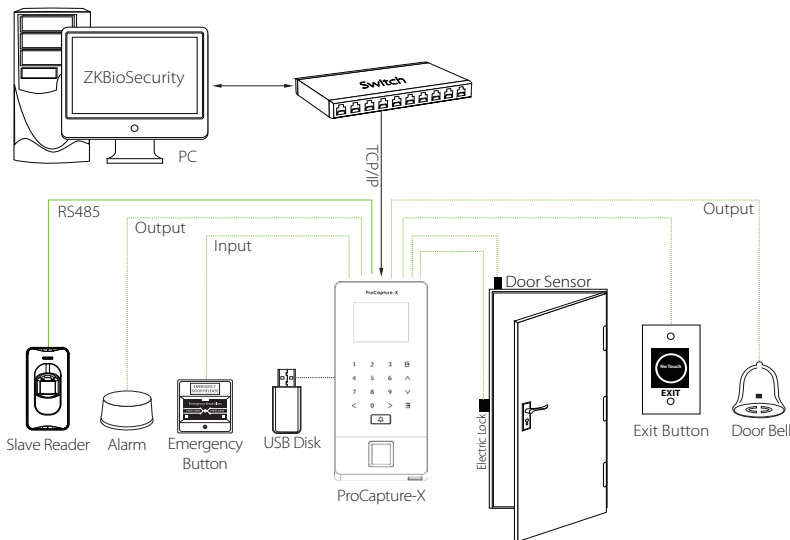

Dimensions

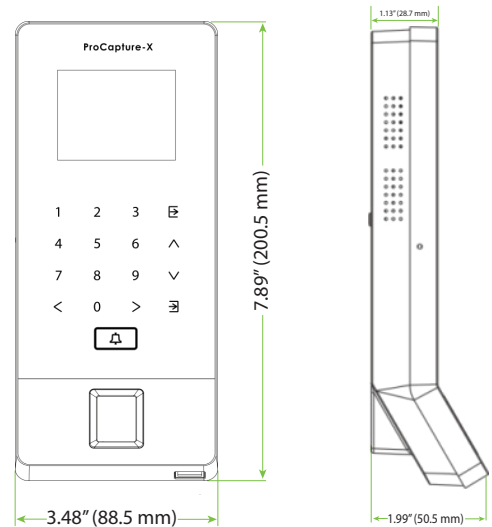

Specifications

Capacity

Fingerprints: 20,000
Cards: 50,000

Access Control Interface

Lock Relay Output
Alarm Output/Auxiliary Input
Exit Button/Door Sensor
Doorbell Output

Communication

TCP/IP, RS485 (for slave reader)
USB Host
Wiegand Input/Output
Optional Wi-Fi available

Hardware

SilkID Fingerprint Sensor
2.4 Inch TFT-LCD Touch Screen
125 kHz ZKAccess Card Reader
Tamper Switch Alarm

Standard Functions

Access Levels/Groups/Holidays
DST/Bell Schedule
Duress Mode (Password)
Anti-Passback
Record Query
Custom Wallpaper & Screen Saver

Software Compatibility

ZKBioSecurity

Additional Info

Working Temperature:
14° F to 122° F (-10° C to 50° C)
Dimensions: 8 x 3.5 x 1 inch
(200.5 x 88.5 x 28.7 mm)
Package Includes: 12V 3A Power Supply

Power

Power over Ethernet
Operating Voltage 12V DC
Current Draw < 500mA

Part Numbers

ProCapture-X

ProCapture-X-Mifare

ProCapture-X-HID

ProCapture-X-iClass

What's in the Box



ProCapture-X

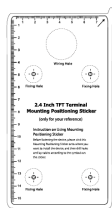

Installation Template

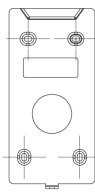

Back Plate

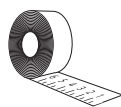

Measuring Tape

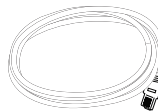

Network Cable



Screws

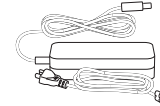

AC Power Adapter

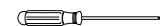

Screwdriver



Cables

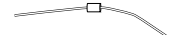

Diode

ZKTeco USA

6 Kingsbridge Road, Unit 8, Fairfield, NJ 07004

Phone: (862) 505-2101 • Fax: (862) 204-5906 • sales@zkaccess.com • www.zkaccess.com